



TANK VERTICAL T 6L  
NO KIT  
298122



298122-



298122-



298122-

## FEATURES

The Vertical T tank is an auxiliary tank, an ideal solution for transporting fuel (gasoline or diesel), on any roll bar or metal structures with circular section of vehicles: SXS / SSV / ATV / 4x4 vehicles.

With a capacity of 6L (1.58 gallons), it allows you to have a reserve of fuel in all those situations where the original tank does not have a sufficient amount of fuel to be able to cover the necessary kilometers of our journey/ competition.

Equipped with steel supports capable of adapting to the most popular vehicles SXS / SSV / ATV / Vehicles 4x4 , in different sizes of the diameter of the bar.

The tank can be quickly disassembled from the supports that, remain fixed on the chassis of the vehicle, allowing a quick refill of fuel in the tank of the vehicle.

Leaning against the ground, it keeps the vertical position autonomous, so that it can be filled with ease.

Large handle allows an easy and balanced transport by hand.

### CONSTRUCTION AND DESIGN:

Auxiliary tank with vertical development

Capacity 6L (1,58 GAL)

Weight 1500g

Dimensions 63x12,5x12,5 cm

Central grip handle for easy movement

Suitable for inserting gasoline or diesel

Shock resistant

### DIMENSIONS AND APPLICATIONS:

Collar suitable for tubular frames of SXS / SSV / ATV / 4x4 vehicles of 50mm diameter (2") adaptable via a rubber strip up to 38mm diameter (1.5")

Distance between vehicle tube and tank: 10mm

# TANKS / AUXILIARY TANKS

## TANK VERTICAL T 6L NO KIT

---

**ACERBI**

### PRODUCT DETAILS

POLIETILENE 90% | Nylon 7% | Other 3%

Made In: Italy

---

### PRODUCTS RELATED



298123  
MOUNTING KIT TANK 0024917.

---

### SIZES

ASSEMBLATO

**MOUNTING KIT TANK  
0024917.**  
298123

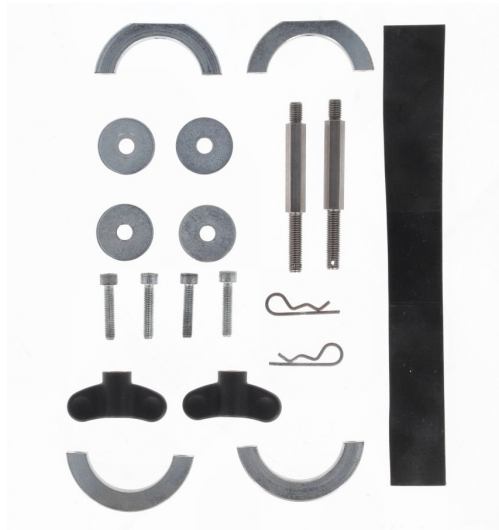

298123-

**PRODUCTS RELATED**



298122  
TANK VERTICAL T 6L NO KIT

■ 090.700 ■ 110.700  
■ 120.700



298121  
VERTICAL T TANK 6L

■ 090.700 ■ 110.700  
■ 120.700



VERTICAL T TANK 6L  
298121



298121-



298121-



298121-

FEATURES

The Vertical T tank is an auxiliary tank, an ideal solution for transporting liquids/seeds, on any roll bar or metal structures with circular section of vehicles:

With a capacity of 6L (1.58 gallons), it allows you to have reserve liquids if needed.

Equipped with steel supports capable of adapting to the most popular mountain bars.

The tank can be quickly disassembled from the supports that, remain fixed on the chassis of the vehicle, allowing a quick transfer.

Leaning against the ground, it keeps the vertical position autonomous, so that it can be filled with ease.

Large handle allows an easy and balanced transport by hand.

CONSTRUCTION AND DESIGN:

Auxiliary tank with vertical development

Capacity 6L (1,58 GAL)

Weight 1500g

Dimensions 63x12,5x12,5 cm

Central grip handle for easy movement

Suitable for liquids/seeds and water

Shock resistant

DIMENSIONS AND APPLICATIONS:

Collar suitable for tubular frames 50mm diameter (2") adaptable via a rubber strip up to 38mm diameter (1.5")

Distance between vehicle tube and tank: 10mm

**TANKS / AUXILIARY TANKS**  
**VERTICAL T TANK 6L**



---

**PRODUCT DETAILS**

POLIETILENE 90% | Nylon 7% | Other 3%

Made In: Italy

---

**SIZES**

FINITO | ASSEMBLATO | T.10

**MOUNTING KIT TANK**  
278008

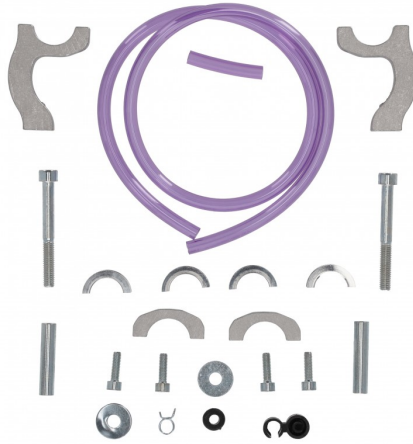

278008-

**PRODUCTS RELATED**



230033  
HANDLEBAR TANK

030

**HANDLEBAR TANK**  
230033



230033-42

**FEATURES**

Height 150 mm. - width 390 mm. - depth 140 mm.  
Capacity 2,1 L

**PRODUCTS RELATED**



278008  
MOUNTING KIT TANK

**SIZES**

FINITO | ASSEMBLATO

**TANKS / AUXILIARY TANKS**  
**FRONT TANK 3LT.**

**ACE3iD**

**FRONT TANK 3LT.**  
**204402**



204402-42

**FEATURES**

3 lit.: height 270 mm. - width 240 mm. - depth 80 mm.

**SIZES**

FINITO | ASSEMBLATO



**FRONT TANK 5 LIT.**  
**204403**



204403-42

**FEATURES**

5 lit.: height 270 mm. - width 240 mm. - depth 130 mm.

**SIZES**

FINITO | ASSEMBLATO

**REAR TANK 6 LIT.**  
**204404**



204404-42

**FEATURES**

Height 170 mm. - width 300 mm. - depth 240 mm.

**SIZES**

FINITO | ASSEMBLATO